

# DIMM

## INSTALLATION GUIDE

### Preparation

For safe operation, see "Safety information", *Setup Guide*.

### CAUTION:

- Do not touch the inside of the printer board compartment. It may cause a machine malfunction or a burn.

### Important

- ☐ Before touching the DIMM, touch something metal to discharge any static electricity. Static electricity can damage the DIMM.

## Installing the DIMM

- 1 Turn off the power.
- 2 Unplug the power cord, and then disconnect the interface cable.
- 3 Pull out the first paper tray (Tray 1) and take the screwdriver (①) from the tray. Each screw to be removed requires this screwdriver.

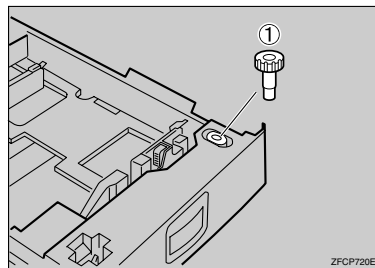

- 4 Remove the two screws that fasten the printer board in place.

The removed screws will be used in step 9 to fasten the printer board again.

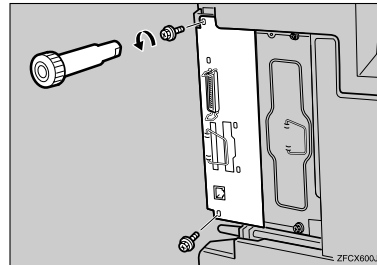

- 5 Hold the handle and carefully pull out the printer board.

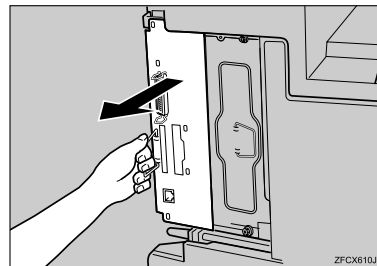

- 6 Put the printer board on a flat surface.

- 7** Insert the DIMM into the slot, and push it down until it clicks. If the DIMM is not set in the correct way it does not click.

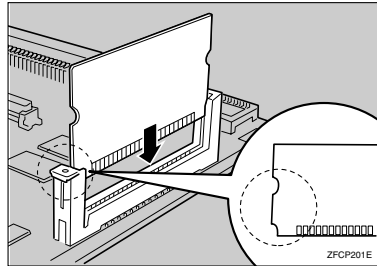

- 8** Align the printer board with the top and bottom rails in the printer, and then slide in the printer board slowly until it stops.

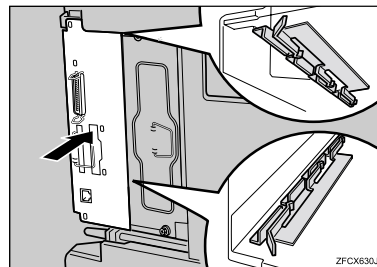

- 9** Fasten the printer board with the two screws you removed in step 4.

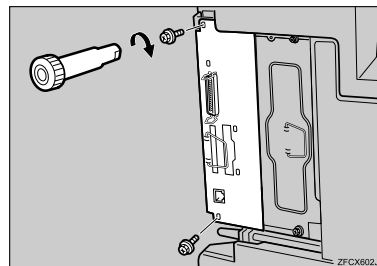

- 10** Attach the interface cable, and then plug in the power cord.

- 11** Turn on the power.

**Note**

- ☐ Be sure to return the screwdriver to the paper tray after using it.
- ☐ After finishing installation, print the configuration page from the "List/Test Print Menu" to confirm that the DIMM is installed properly. See "List/Test Print Menu", *Printer Reference*, on the CD-ROM labeled "Operating Instructions".